

DK-8052

Amazing apartment in Playa Flamenca – Your dreamhome in the sun

 Playa Flamenca, Alicante

€399,000





Overview

Specifications

Bedrooms

 3

Bathrooms

 2

Covered

 101 m²

Type **Apartment**

Status **Resale**

Year of construction **2021**

Furnished **Fully furnished**

Communal charge **€1,900**

Energy efficiency rating  **B**

Description

Dreaming of a modern oasis close to everything your heart desires?

This beautiful ground-floor apartment in Flamenca Village could be just what you're looking for! With 3 spacious bedrooms, all featuring built-in wardrobes, and a bright, open living room seamlessly connected to an elegant, stylish kitchen, this space is perfect for cozy moments and dinner gatherings.

And as the finishing touch, the apartment offers a fantastic south-facing terrace, partially covered – ideal for morning coffee or an afternoon in the sun.

The apartment is air-conditioned throughout, allowing easy temperature control to suit your mood and the season, and it's sold furnished, ready for you to move in.

Extra conveniences that make daily life easy;

The apartment includes a private parking space in the basement and a locked storage room – perfect for your beach chairs, bikes, and all the things that make holiday life comfortable.

Close to the front door, you'll find both an elevator and stair access for ease and convenience.

Shared amenities with a luxury resort feel;

The gated Flamenca Village complex, built by the renowned TM, has everything you could wish for. Dive into the lovely shared pools, complete with sunbathing areas, enjoy a quiet moment in the jacuzzi, or stay fit in the well-equipped gym. It's pure perfection!

An ideal location with everything within reach;

Located in the heart of Playa Flamenca, you'll be close to everything – just a few hundred meters from Mercadona supermarket, cozy restaurants, bars, and small shops in a nearby center.



Floor plans

FLAMENCA VILLAGETM

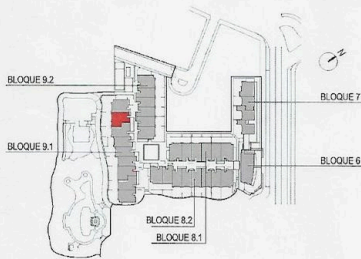

#	SUPERFICIES ÚTILES / FLOOR AREA / SURFACES UTILES	TIPO TYPE	KK0a
1	VESTIBULO / HALL / ENTRÉE		3,88 m ²
2	PASO 1 / CORRIDOR 1 / CIRCULATION 1		1,65 m ²
3	PASO 2 / CORRIDOR 2 / CIRCULATION 2		1,87 m ²
6	COCINA / KITCHEN / CUISINE		6,82 m ²
7	GALERÍA / GALLERY / GALERIE		2,44 m ²
1	SALÓN COMEDOR / LIVING-DINING ROOM / SALON-SALLE A MANGER		22,43 m ²
9	DORMITORIO 1 / BEDROOM 1 / CHAMBRE 1		15,88 m ²
10	DORMITORIO 2 / BEDROOM 2 / CHAMBRE 2		16,47 m ²
11	DORMITORIO 3 / BEDROOM 3 / CHAMBRE 3		9,58 m ²
12	BAÑO 1 / BATHROOM 1 / SALLE DE BAINS 1		4,35 m ²
13	BAÑO 2 / BATHROOM 2 / SALLE DE BAINS 2		3,88 m ²
14	TRASTERO / STOREROOM / CAVE		4,88 m ²
32	ZAPATERO / SHOE LOCKER / PLACARD A CHAUSSURES		0,52 m ²
TOTAL SUP. ÚTILES / TOTAL FLOOR AREA / TOTAL SURFACES UTILES			
SUP. CONSTRUIDA INTERIOR / BUILT INTERIOR AREA / SURFACE CONSTRUITE INTERIEUR			101,20 m ²
16	SUP. CONSTRUIDA PORCHE / BUILT PORCH AREA / SURFACE CONSTRUITE PORCHE		37,88 m ²
22	SUP. CONSTRUIDA TERRAZA DESCUBIERTA / BUILT OPEN TERRACE AREA / SURFACE CONSTRUITE TERRASSE NON COUVERTE		2,98 m ²
TOTAL SUP. CONSTRUIDA PRIVADA / TOTAL BUILT PRIVATE AREA / TOTAL SURFACE CONSTRUITE PRIVEE			138,06 m ²
SUP. JARDIN desde-hasta / GARDEN AREA from-to / SURF. JARDIN de-à			27 m ²

TIPO/TYPE KK0a

Apartamento, 3 Dormitorios + 2 Baños - Planta Baja
 Apartment, 3 Bedrooms + 2 Bathrooms - Ground Floor
 Appartement, 3 Chambres + 2 Salles de bains - Rez-de-chaussée

KK0b

VAREIDAD DE TIPOS POR TERRAZAS

TOTAL SUP. ÚTILES	87,42 m ²
SUP. CONSTRUIDA INTERIOR	101,20 m ²
16 SUP. CONSTRUIDA PORCHE	37,71 m ²
22 SUP. CONSTRUIDA TERRAZA DESCUBIERTA	6,15 m ²
TOTAL SUP. CONSTRUIDA PRIVADA	138,06 m ²

NOTA: El Porche puede variar en función de la ubicación de la vivienda. Ver Planos de Planta.
 NOTE: The Porch may vary depending on the location of the house. See floor view plans.
 NOTE: Le Porche peut varier en fonction de l'emplacement du logement. Voir plans d'étage.



Marzo/March/Mars 2020

Plano sujeto a posibles modificaciones por razones o exigencias de índole técnica o jurídica. Las superficies son aproximadas. Cocina y amueblamiento orientativo, sin valor contractual.
 Plans subject to possible modifications for technical or legal reasons. Measurements shown are approximate. Kitchen and furnishings are for display purposes only, with no contractual value.
 Plan soumis à modifications en fonction des besoins ou exigences d'ordre technique ou juridique. Les surfaces sont approximatives. Cuisine et ameublement indicatifs, sans valeur contractuelle.



Additional information

Facilities

Aircondition, Central system

Gated complex

Parking, Underground

Spa

Childrens playground

Gym

Pool, Communal

Storage

Elevator

Heating, Central

Sauna

Features

24-hour security

Double glazing

En suite bathroom

Fitted wardrobes

Kitchen appliances

Open plan

Thermal insulation

Bicycle parking

Easy access to highway

Entrance gate

Garden

Near amenities

Rental potential

Utility room

Bright

Easy access to main roads

Entrance gate, automated

Internet

Near bus route

Shutters

Walking distance to beach

Distances

Amenities

 200 m

Airport

 50 km

Sea

 750 m

